



DUFOUR 375 GRAND LARGE

DUFOUR 375 GRAND LARGE

BROKER'S COMMENTS

Striking design by Umberto Felci and the Dufour design team. Airy and light interior with lots of windows and opening portholes for comfortable stays onboard. With her two cabin owner layout the space onboard is even better and has more than ample storage space throughout. Sailing and handling the Dufour cruising yachts have a good reputation and the Dufour 375 surely delivers. In the cockpit the twin steering wheels provide for excellent access and safety. So hop onboard, set the sails and enjoy what she has to offer you.

Marc Weijenberg

SPECIFICATIONS

Dimensions	11.90 x 3.85 x 1.90 (m)	Builder	Dufour Yachts
Built	2012	Cabins	2
Material	GRP	Berths	5
Engine(s)	1 x Volvo Penta D2-40 diesel	Hp/Kw	40.00 (hp), 29.40 (kw)
Asking price	sold (VAT)	Lying	at sales office

CONTACT

Sales office	De Valk Sint Annaland B.V.	Telephone	+31 (0)166 601 000
Address	Koelhuisweg 4 4697 RM Sint Annaland NL	E-mail	sintannaland@devalk.nl

DISCLAIMER

These particulars are given in good faith as supplied but cannot be guaranteed.



DUFOUR 375 GRAND LARGE

GENERAL

Model	DUFOUR 375 GRAND LARGE
Type	sailing yacht
LOA (m)	11,90
LWL (m)	9,89
Beam (m)	3,85
Draft (m)	1,90
Air draft (m)	16,50
Headroom (m)	1,94
Year built	2012
Builder	Dufour Yachts
Country	France
Designer	Umberto Felci
Displacement (t)	7
Ballast (tonnes)	cast iron 1,95
CE norm	A
Hull material	GRP
Hull colour	white
Hull shape	round-bilged
Keel type	fin keel with bulb
Superstructure material	GRP
Deck material	GRP
Deck finish	non-skid moulded in
Superstructure deck finish	non-skid moulded in
Cockpit deck finish	teak
Window material	polycarbonate
Deckhatch	with OceanAir blinds/gauzes 5x
Portholes	aluminium
Fuel tank (litre)	polyethylene 200
Freshwater tank (litre)	polyethylene 200+160
Blackwater tank (litre)	polyethylene 50



DUFOUR 375 GRAND LARGE

Blackwater tank extraction	deck extraction + uw line
Wheel steering	cable steering 2 x Lewmar
Emergency tiller	yes
Extra info	stainless bow protection vaccuum infused deck mouldings

ACCOMMODATION

Cabins	2
Berths	5
Interior	Moabi mahogany
Floor	wood
Saloon	yes
Headroom saloon (m)	1,94
Heating	diesel ducted hot air Eberspaecher
Chart table	yes
Aft Cabin	yes
Dinette	with sliding seat
Galley	yes
Countertop	corian
Sink	stainless steel 2 x
Cooker	calor gas 2 -burner
Oven	yes
Microwave	Eno (220v)
Fridge	Isotherm 12v 180 ltrs
Hot water system	220V + engine Quick 20 ltr
Water pressure system	electrical
Manual and/or foot pump	yes
Owners cabin	double bed
Bed length (m)	with special Neptune mattress 2,20 x 1,40
Wardrobe	hanging and shelves
Bathroom	shared 1
Toilet	shared



DUFOUR 375 GRAND LARGE

Toilet system	manual
Wash basin	in the bathroom
Shower	separate
Guest cabin 1	double bed
Bed length (m)	2,00 x 1,30
Wardrobe	hanging and shelves
Extra info	extra porthole in aftcabin

MACHINERY

No of engines	1
Make	Volvo Penta
Type	D2-40
HP	40,00
kW	29,40
Fuel	diesel
Year installed	2012
Maximum speed (kn)	7,5
Cruising speed (kn)	6,5
Consumption (l/hr)	3
Engine hours	874
Engine cooling system	freshwater heat exchanger
Drive	sail-drive
Saildrive seal	(2012)
Engine controls	bowden cable
Exhaust	watercooled
Propeller type	feathering Autoprop APS-H5
Propeller blades	3
Manual bilge pump	1 x
Electric bilge pump	1 x
Electrical installation	12/220v
Start battery	1 x (2017)



DUFOUR 375 GRAND LARGE

Service battery	2 x 105amp (2017)
Battery monitor	BTMIII
Battery charger	Cristec 12v/25amp
Shorepower	with cable

NAVIGATION

Compass	2 x Plastimo Offshore 135
Electric compass	via autopilot
Depth sounder	Raymarine I70
Log	Raymarine I70
Windset	Raymarine I70
VHF	Garmin 100i
Autopilot	+ P70 control panel Raymarine SPX30
Rudder angle indicator	via autopilot
Plotter/GPS	Raymarine C90W
AIS transponder	Raymarine AIS650 Class B
Navigation lights	LED

EQUIPMENT

Sprayhood	(2014)
Bimini	(2014)
Winter cover	(2013)
Cockpit table	yes
Bathing platform	folds open
Boarding ladder	stainless steel
Deck shower	hot + cold
Anchor	Delta
Anchor chain	chain + line
Windlass	electrical Quick 12v/1000watt
Outboard support	yes
Sea railing	wire



DUFOUR 375 GRAND LARGE

Grab rail (superstructure)	stainless steel
Railing side opening gates	2 x
Pushpit	yes
Pulpit	yes
Radar reflector	Tri-lens
Fenders	yes
Mooring lines	yes
Radio-cd player	Kenwood + USB
Cockpit speakers	yes
Speakers in salon	yes
Clock - barometer	yes
Fire extinguisher	(2012)

RIGGING

Rigging	sloop
Standing rigging	wire
Brand mast	Sparcraft
Material mast	aluminium
Spreaders	2 sets
Mainsail cover	Lazy Bag + Laxy Jacks
Fully battened mainsail	Offshore (2012) Elvstrom
Genoa	Offshore (2012) Elvstrom
Genoa furler	Facnor
Genoa cover	Elvstrom
Stormjib	(fitted over genoafurler) Elvstrom
Reefing System	quick-one-line-reefing
Backstay adjuster	tackle
Boomvang	mechanical
Genoa sheetwinches	2 x Lewmar 40ST
Halyard winches	2 x Lewmar 40ST
Gennaker pole	aluminium



DUFOUR 375 GRAND LARGE

Extra info

Waler 203C boombrake Adjustable sheet-cars German main-sheeting Grand Prix package incl 70cm taller mast + gennaker equipment



DUFOUR 375 GRAND LARGE



DUFOUR 375 GRAND LARGE



DUFOUR 375 GRAND LARGE



DUFOUR 375 GRAND LARGE



DUFOUR 375 GRAND LARGE



DUFOUR 375 GRAND LARGE



DUFOUR 375 GRAND LARGE



DUFOUR 375 GRAND LARGE



DUFOUR 375 GRAND LARGE



DUFOUR 375 GRAND LARGE



DUFOUR 375 GRAND LARGE



DUFOUR 375 GRAND LARGE



DUFOUR 375 GRAND LARGE



DUFOUR 375 GRAND LARGE

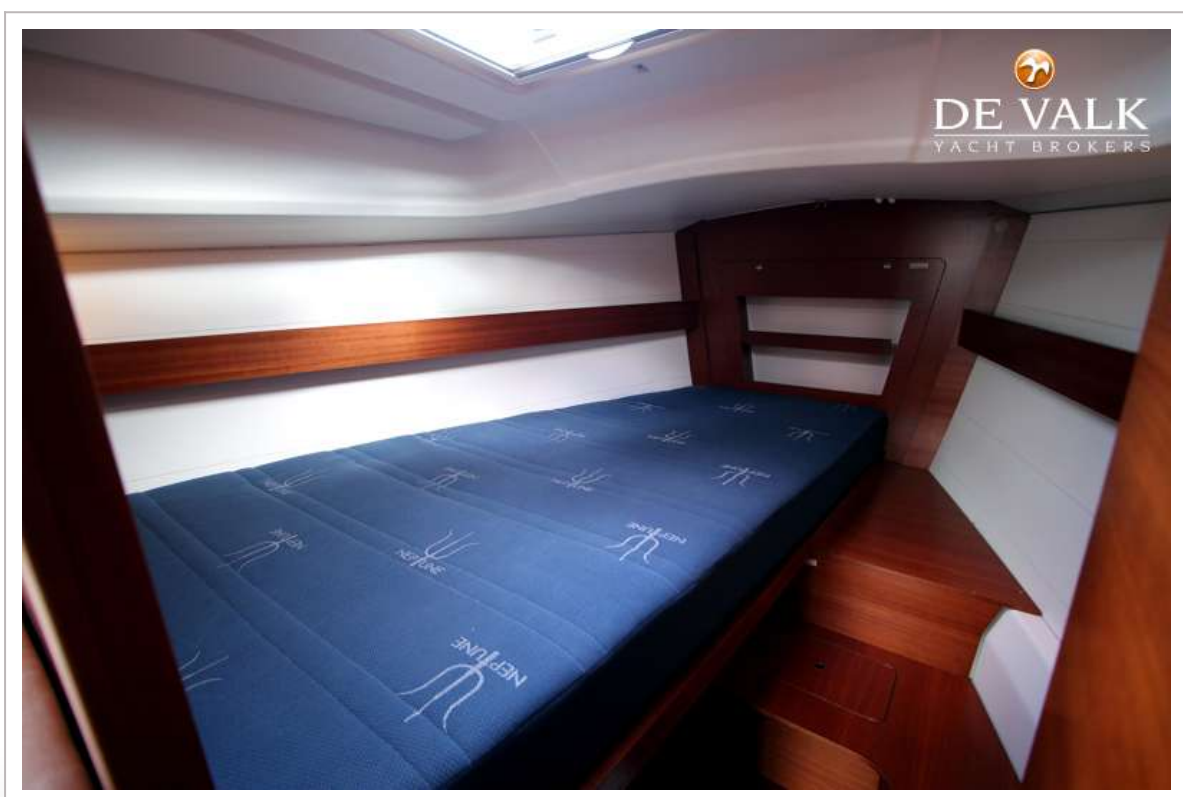
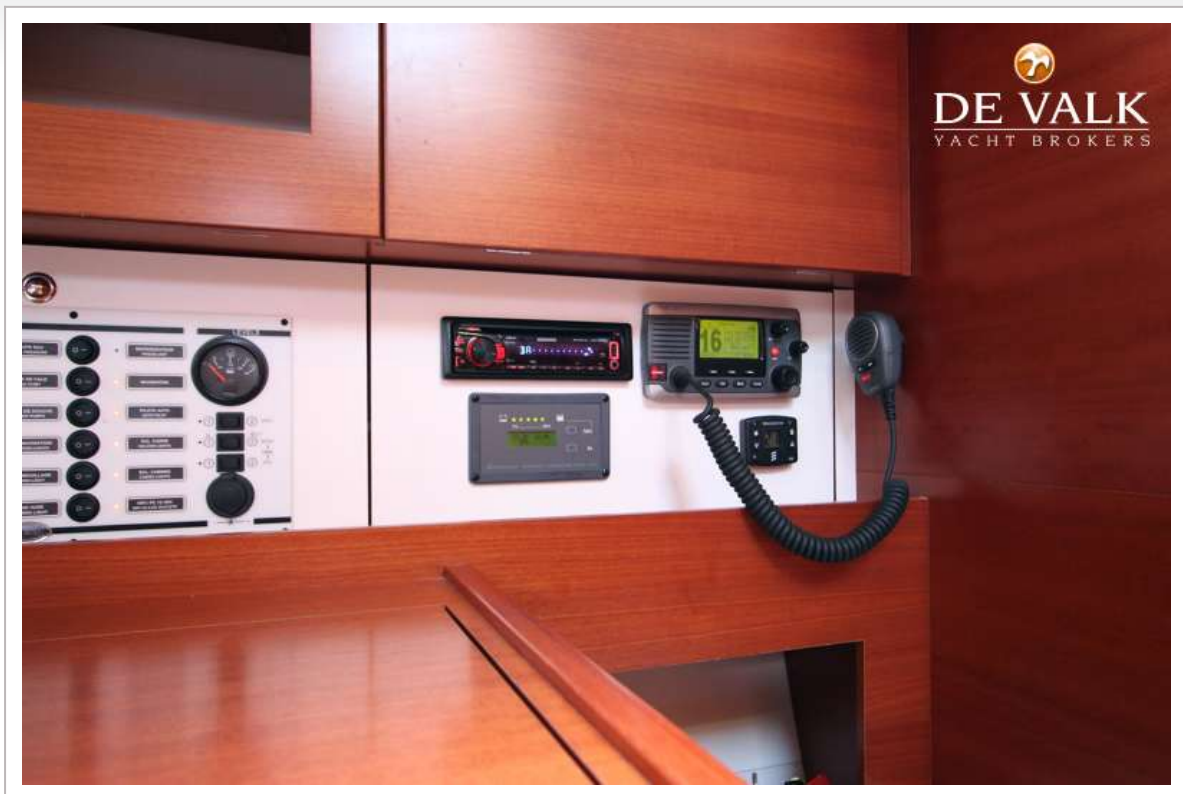

DUFOUR 375 GRAND LARGE



DUFOUR 375 GRAND LARGE



DUFOUR 375 GRAND LARGE



DUFOUR 375 GRAND LARGE



DUFOUR 375 GRAND LARGE

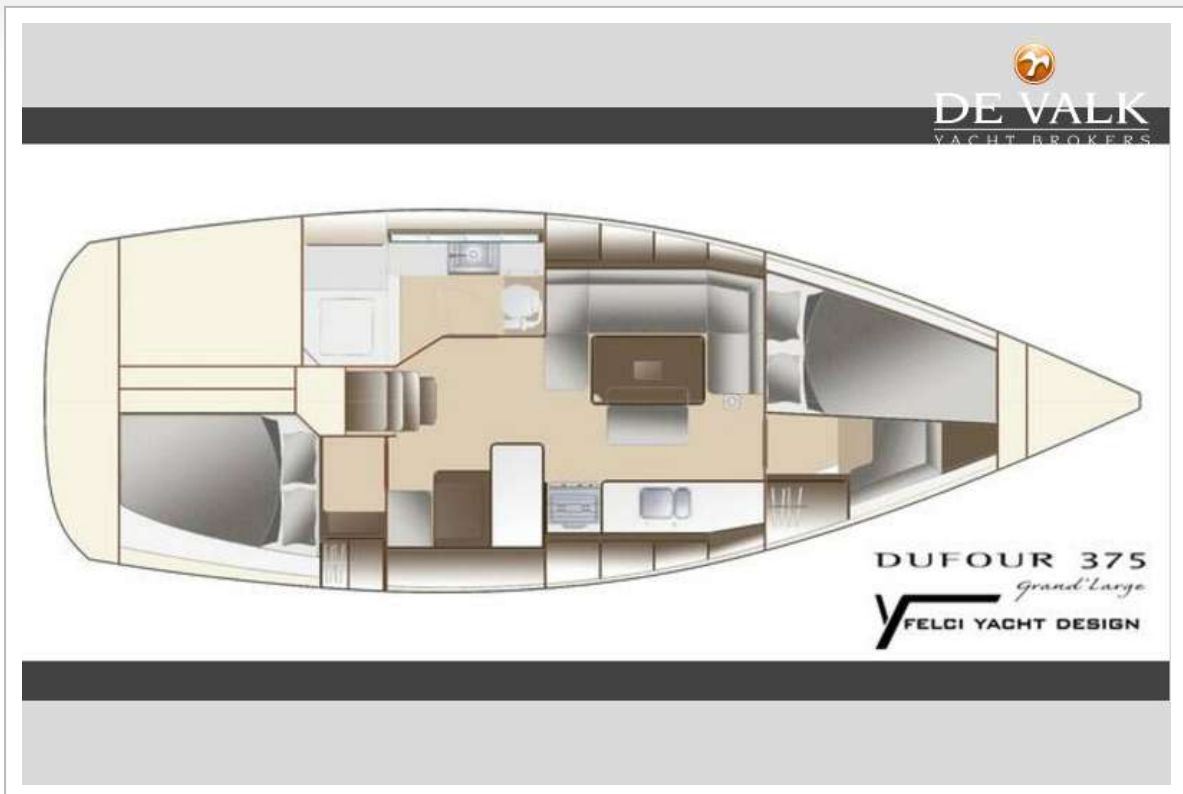

DUFOUR 375 GRAND LARGE

